

MODELS 722 & 726

45° TOP MOUNT DRIVE

LIGHT DUTY 2 1/2" PITCH HINGED STEEL BELT CONVEYOR

(M726 is a liquid tight M722)

This unit has a shallow frame of 6 5/8" which allows it to fit into tighter spaces other 2 1/2" pitch units can't. Its smaller overall construction and the corresponding tighter tolerances makes this the ideal choice when conveying small and more finite scrap.

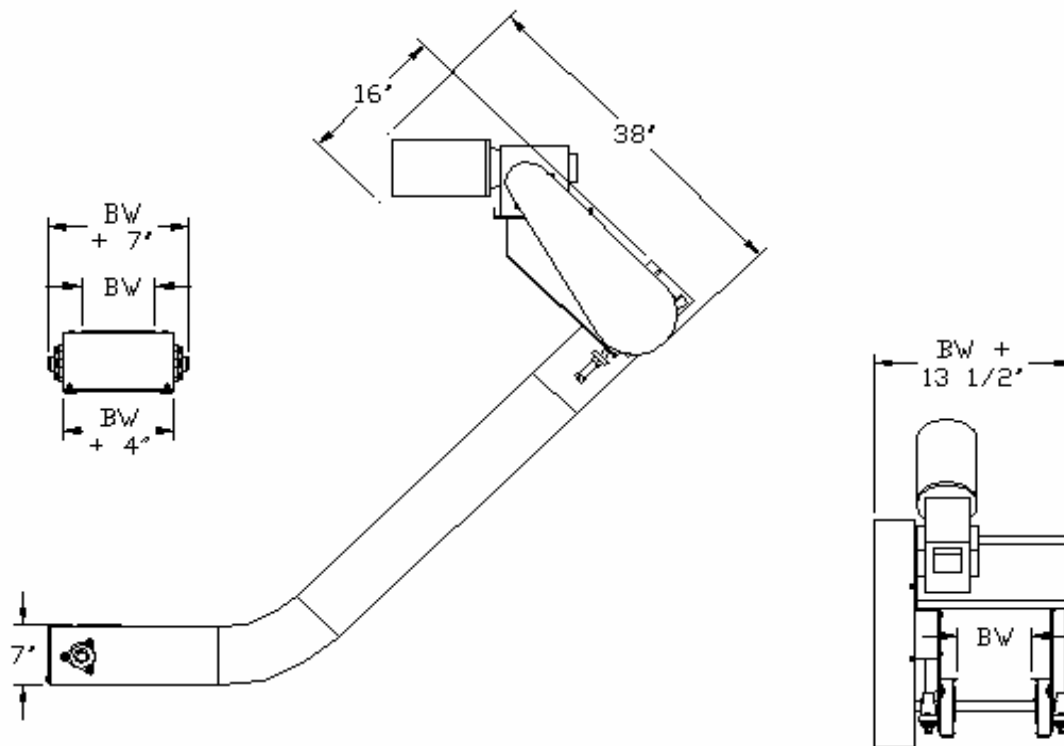

45° TOP MOUNT DRIVE

45° TOP MOUNT DRIVE

1700 Division Street, New London, WI 54961

Phone: (800) 437-1994

Fax: (920) 982-6800

www.nleco.com